

变更标记	日期	变更内容	签名	核准

**Material & finish**

SHELL:

steel  
Zinc plated, Tin plated  
or Nickel plated steel

PIN CONTACT:

Phosphor bronze or brass  
Gold Plated

INSULATOR:

PBT & Glass-fibre reinforced  
UL-94-V0

NUMBER OF CONTACT:

CURRENT RATING:

5Amp

DIELECTRIC STRENGTH:

1000V for one minute

INSULATOR RESISTANCE:

1000Mh MIN. (at 500V DC)

TEMPERATURE:

-55°C to +105°C

**HR-X S X V X X D O C O**

Pin: 15 26 44 62

SHELL PLATING  
A: Gold N: Nickel T: Tin

COLOUR  
B: Blue K: Black W: White 2: 6610  
blue 3: 235C Red 4: 322C green  
6: 1310Yelliv

Contact Finish  
A: Gold Flash C: Gold Flash3U" D: Gold Flash5U" E: Gold Flash15U"  
F: Gold Flash30U" G: Gold T: Tin

POS.	A	B	C	D
15	30.8	25.0	16.3	2.29
26	39.2	33.32	24.7	2.29
44	53.1	47.04	39.0	2.29
62	70.0	63.5	55.4	2.41

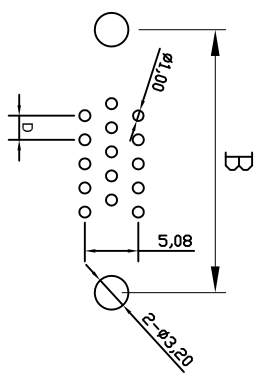
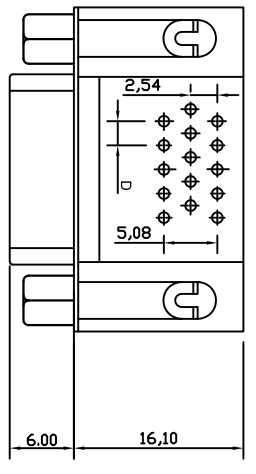
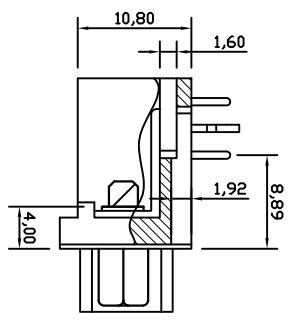
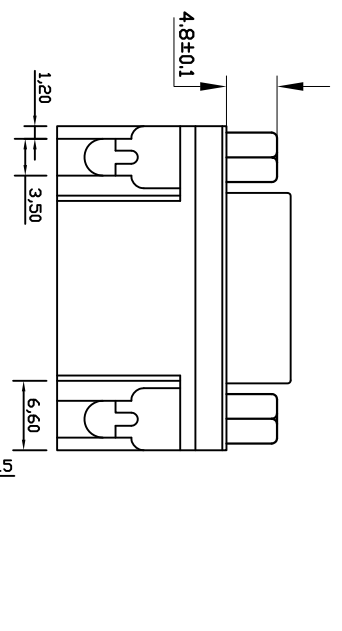

**东莞扬顺五金电子有限公司**  
Dong Guan City Yang Shun Hardware Electron Co., Ltd

未注公差

设计 刘峰

品名规格 DHR-15/62 母锁合Z字片 前锁  
4.8螺丝

审核 核准 料号 日期 2017.11.22 图号 YS-11-0193

单位 mm 比例 1:1 版次 A/0

X. ±0.30  
XX ±0.20  
XXX ±0.10  
XXXX ±0.05  
X.\* ±2° X.X\* ±1°

